



maintrac-Diagnostics

Determination of the tumor cell number & therapy-relevant properties

- *Lab request form*
(completely filled, signature of the patient)
- *15ml EDTA blood*
(patient name written on the tube together with date of birth and sample date)

Drug testing

- *please sent a daily dose of the medication or alternative remedy after consultation of our medical laboratory.*
- *Lab request form*
(completely filled, signature of the patient)
- *15ml EDTA blood*
(sufficient for testing up to 7 drugs, patient name written on the tube, together with date of birth and sample date)

Specialized Medical Laboratory

Dr. Pachmann

Kurpromenade 2

95448 Bayreuth, Germany

Phone: +49 (0) 921 850200



Since 2005, maintrac is performed by the DIN EN ISO 15189 accredited specialized medical laboratory Dr. Pachmann.



Sample Transportation

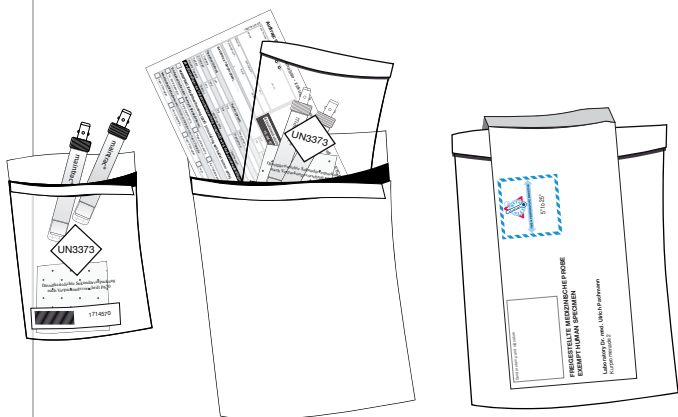

Shipment instructions

- Shipment via courier (i.e. FedEx or DHL)
- Shipment has to arrive within 48-72h
- Please send the blood sample together with the lab request form to the address on this leaflet.
- Shipment should take place at room temperature (no cooling)
- Please mark the shipment as "EXEMPT HUMAN SPECIMEN".

Results

- Results will be sent usually 5 days after receiving the sample.
- If you have medical questions please ask our medical laboratory Dr. Pachmann directly.

Further information is also available on the Web:
www.maintrac.com